

Radial Type Super Capacitor – JGW

STRUCTURE

- This product adopts the shape of a cylindrical capacitor. The interior is a wound structure, and the positive and negative electrodes are separated by a separator and impregnated with electrolyte components; the aluminum casing is sealed with a rubber stopper, the lead-out method is wire lead-out, and the lead-out pole is on the same side of the product.

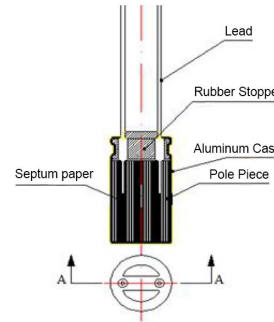

APPLICATIONS

- Smart meter: smart electricity meter, smart water meter, smart gas meter
- Car electronics: car audio, ETC system, driving recorder
- IoT 5G: smart TV, smart refrigerator, smart electronic door, anti-theft system, 5G terminal
- Backup power supply: communication equipment, wireless transmission, RAM, UPS, small household appliances, small energy storage devices, green energy, solar street lights

SPECIFICATIONS

Items	Performance Characteristics
Operating Voltage Range	2.5V~3.8V
Surge Voltage	4.2V
Cut-off discharge voltage	2.5V
Cap. Tolerance	-20%~+20%
Self Discharge (3months)	3.0V
Cycle life Expectancy	Normal temperature cycle life: 250,000times. $\Delta C/C$ $\leq 30\%$, $ESR \leq 2$ times the specified value
High temperature load	+65°C rated voltage, or +85°C 3.5V voltage, after 1000h, $\Delta C/C$ $\leq 30\%$, $ESR \leq 2$ times the specified value
High temperature without load	+65°C, after 1000h, $\Delta C/C$ $\leq 30\%$, $ESR \leq 2$ times the specified value
Temperature characteristics	+70°C $\Delta C/C$ $\leq 30\%$, $ESR \leq$ specified value; -20°C $\Delta C/C$ $\leq 50\%$, $ESR \leq 4$ times the specified value
The steady state damp heat test	+40°C, 90--95%RH, 240h, $\Delta C/C$ $\leq 30\%$, $ESR \leq 2$ times the specified value

DIMENSIONS (mm)

Fig 1

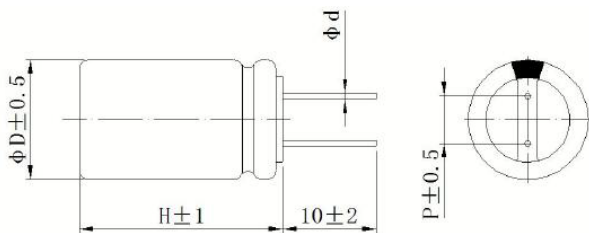

φD	P	φd
6.3	2.5	0.5±0.05
8	3.5	0.6±0.1
10	5.0	0.6±0.1
12.5	5.0	0.6±0.1

Fig 2

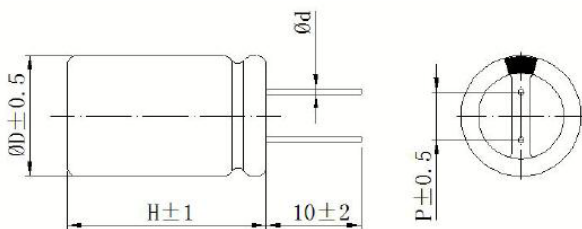

φD	P	φd
16	7.5	0.8±0.05
18	7.5	0.8±0.05

Please visit our website to get more update data, those data & specification are subject to change without notice.

Radial Type Super Capacitor – JGW

STANDARD RATINGS

Rated Cap. (F)	Size ϕ DxH (mm)	ESR DC (m Ω)	ESR AC (1KHz) (m Ω)	Rated Current (A)	Pulse Current (A)	Leakage Current (μ A)	Dimensions (mm)
Rated voltage: 3.8V; Operating Temp. : -20$^{\circ}$C~60$^{\circ}$C							
6.5	6.3x10	7000	3500	0.03	0.20	4.0	Fig 1
8	6.3x12.5	7000	3500	0.04	0.25	4.0	Fig 1
10	8x13	2200	800	0.06	0.35	5.0	Fig 1
15	6.3x22	2000	800	0.08	0.45	5.5	Fig 1
20	8x16	1000	500	0.10	0.55	6.0	Fig 1
30	8x20	900	300	0.15	0.90	6.5	Fig 1
38	8x24	700	200	0.20	1.00	7.0	Fig 1
40	8x20	600	200	0.22	1.00	7.0	Fig 1
40	10x16	600	200	0.22	1.00	7.0	Fig 1
50	10x20	600	200	0.28	1.40	7.0	Fig 1
70	10x25	320	120	0.40	2.30	9.0	Fig 1
80	10x20	320	120	0.45	2.50	12.0	Fig 1
100	10x30	250	100	0.60	3.00	13.0	Fig 1
120	12.5x21	250	100	0.70	3.50	18.0	Fig 1
150	12.5x25	250	100	0.80	4.50	20.0	Fig 1
250	12.5x34	200	70	1.40	7.50	30.0	Fig 1
300	16x26	200	70	1.60	9.00	40.0	Fig 2
500	16x34	150	50	2.80	16.00	65.0	Fig 2
800	18x41	80	30	4.50	26.00	110.0	Fig 2
1000	18x60	60	25	5.50	36.00	130.0	Fig 2

Please visit our website to get more update data, those data & specification are subject to change without notice.

Radial Type Super Capacitor – JGW

DIMENSIONS (mm)

Fig 3

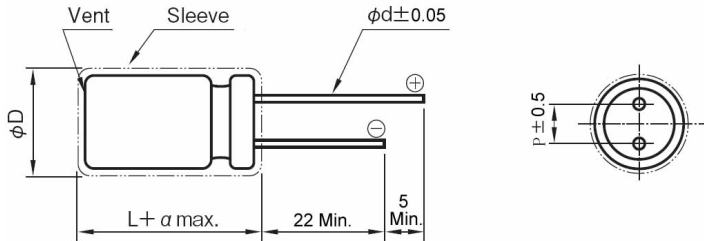

ΦD	P	Φd	α
6.3	2.6	0.5	1.5
8	3.5	0.6	1.5
10	5.0	0.6	2.0
12.5	5.0	0.6	2.0
16	7.5	0.8	2.0
18	7.5	0.8	2.0

STANDARD RATINGS

Rated Cap. (F)	Size φDxH (mm)	ESR DC (mΩ)	ESR AC (1KHz) (mΩ)	Rated Current (A)	Max. Current (≤3sec) (A)	Leakage Current (μA)	Dimensions (mm)
Rated voltage: 3.8V; Operating Temp. : -25°C~70°C							
3	5*12	9000	4000	0.015	0.1	1.8	Fig 3
8	6.3*12	2600	1200	0.04	0.25	2.0	Fig 3
20	6.3*22	1000	450	0.11	0.7	3.5	Fig 3
25	8*14	900	400	0.125	0.8	2.5	Fig 3
40	8*20	550	250	0.2	1.2	3.2	Fig 3
55	8*25	450	200	0.275	1.8	5.0	Fig 3
50	10*16	450	200	0.275	1.8	5.0	Fig 3
60	12.5*13	400	200	0.3	2.0	8.0	Fig 3
80	10*20	250	120	0.425	3.5	8.0	Fig 3
100	10*25	220	90	0.55	4	9.0	Fig 3
150	10*30	140	70	0.75	6	15.0	Fig 3
200	12.5*25	135	65	1	6	18.0	Fig 3
300	12.5*35	100	50	1.5	10	30.0	Fig 3
350	12.5*40	90	45	1.75	11	35.0	Fig 3
400	12.5*45	80	45	2	12	70.0	Fig 3
450	16*30	60	40	2.25	15	70.0	Fig 3
850	18*40	70	35	4.25	28	70.0	Fig 3
1000	18*50	65	30	5	30	100.0	Fig 3
1400	18*60	50	20	7	40	120.0	Fig 3

Please visit our website to get more update data, those data & specification are subject to change without notice.