

## JBR-BT Wirewound Resistor

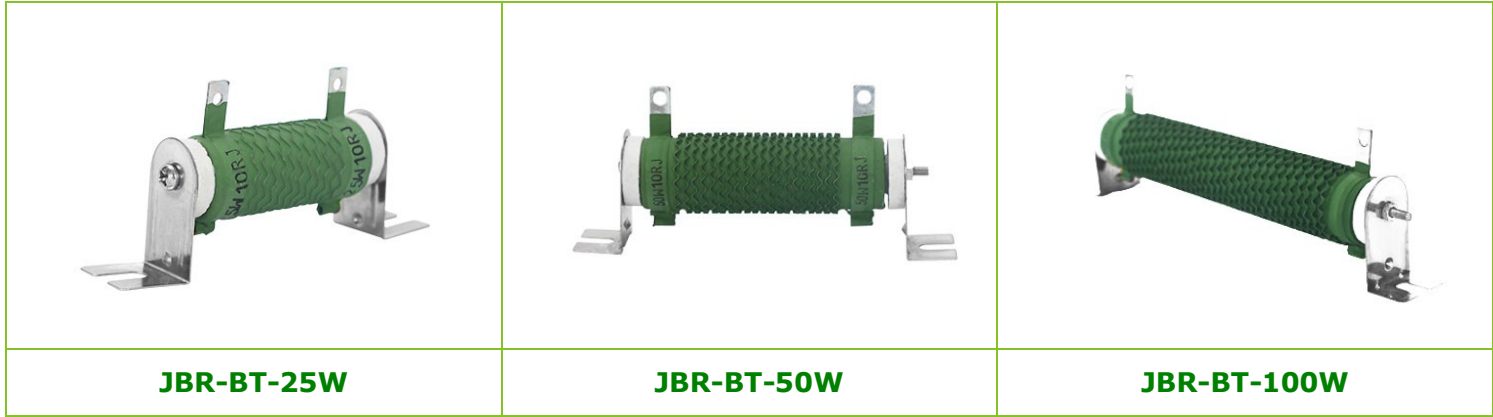

### Common Dimensions

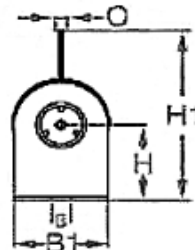
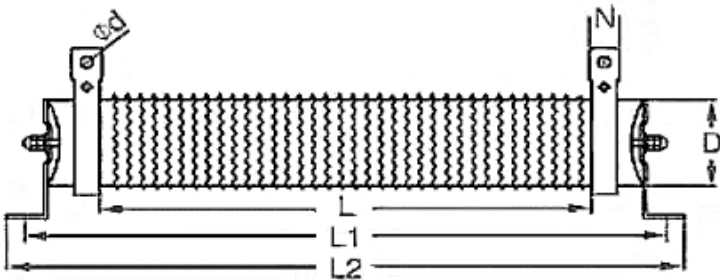

## JBR-BT Wirewound Resistor

Rated Power(W)	Dimension(mm)										
	L±2	L1±5	L2±3	D±2	B	B1	H	H1±3	N	∅d	O
50	102	124	146	28	6.5	28	28	61	10	4.5	1.5
60	102	124	146	28	6.5	28	28	61	10	4.5	1.5
80	152	174	196	28	6.5	28	28	61	10	4.5	1.5
100	182	204	226	28	6.5	28	28	61	10	4.5	1.5
120	182	204	226	28	6.5	28	28	61	10	4.5	1.5
150	195	217	239	40	8	40	41	81	12	5.5	2
200	195	217	239	40	8	40	41	81	12	5.5	2
300	282	304	326	40	8	40	41	81	12	5.5	2
400	282	304	326	40	8	40	41	81	12	5.5	2
500	345	367	389	40	8	40	41	81	12	5.5	2
600	316	338	360	50	8	50	45	99	16	6	2
750	316	338	360	50	8	50	45	99	16	6	2
1000	300	325	350	60	8.5	60	59	119	16	6	2
1200	415	440	465	60	8.5	60	59	119	16	6	2
1500	415	440	465	60	8.5	60	59	119	16	6	2
2000	510	535	560	60	8.5	60	59	119	16	6	2
2500	600	625	650	60	8.5	60	59	119	16	6	2

Note: Max. Operating power could reach to 10000W.

Please visit our website to get more update data, those data & specification are subject to change without notice.