

Motor Capacitor CBB60 – JFS

FEATURES

- jb CBB60 plastic case cylindrical JFS-10~21 capacitors with UL and cUL approvals.
- Low D.F. (dissipation factor), good self-healing character
- High I.R. (insulation resistance)
- High safety & High reliability
- Anti-Striking current, strong over-carrier capacity



SPECIFICATIONS

Operating Condition -40°C ~ +85°C
 Capacitance Range 1uF ~ 100uF(JFS-10~21)
 Capacitance Tolerance J(±5%), K(±10%)
 Rated Voltage 250V 450V (AC)
 Withstand Voltage

Withstand voltage test			GB/T3667.1-2016 IEC/EN60252.1
Test area	Test voltage	time	
T-T	rated voltage	2s	
T-C	2400VAC(If all shell made of insulating materials, without any test in this project)	/	

Dissipation Factor ≤0.004 100Hz(JFS-10~21)
 Insulation Resistance ≥3000S

JFS-10

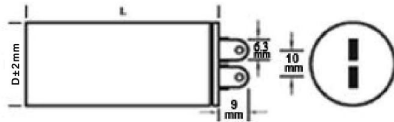

JFS-11

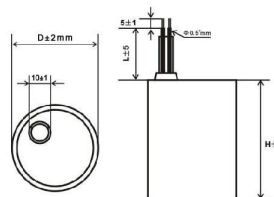

JFS-12

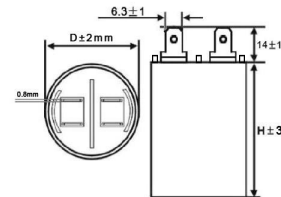

JFS-13

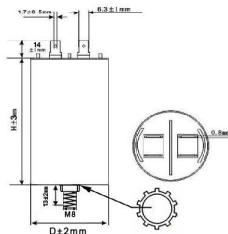

JFS-14

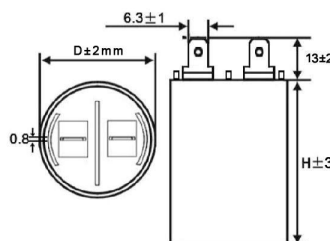

JFS-15

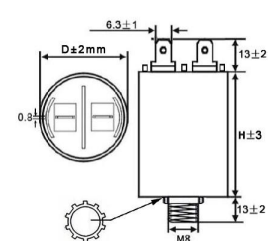

JFS-16

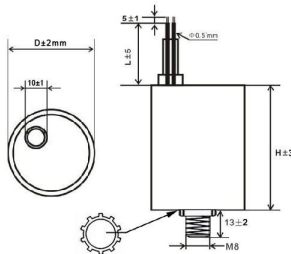

JFS-17

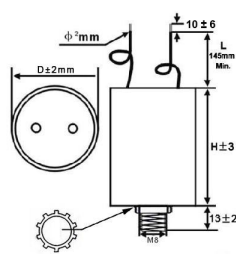

JFS-18

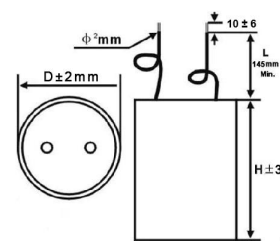

JFS-19(only for D:30mm)

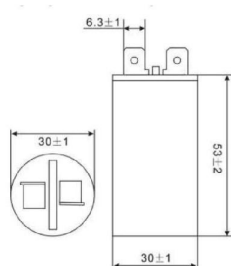

JFS-20

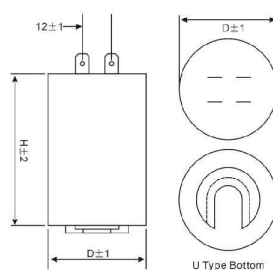

JFS-21

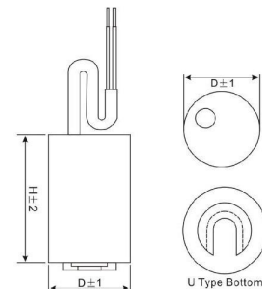

Motor Capacitor CBB60 – JFS

Dimensions For Motor Running Capacitors CBB60

(mm)

CAP	JFS-11				JFS-12				JFS-13				JFS-14			
	250VAC		450VAC		250VAC		450VAC		250VAC		450VAC		250VAC		450VAC	
uF	D	H	D	H	D	H	D	H	D	H	D	H	D	H	D	H
1	30	53	30	53	30	50	30	50	30	57	30	57	30	50	30	50
1.5	30	53	30	53	30	50	30	50	30	57	30	57	30	50	30	50
2	30	53	30	53	30	50	30	50	30	57	30	57	30	50	30	50
2.5	30	53	30	53	30	50	30	50	30	57	30	57	30	50	30	50
3	30	53	30	53	30	50	30	50	30	57	30	57	30	50	30	50
3.5	30	53	30	53	30	50	30	50	30	57	30	57	30	50	30	50
3.75	--	--	--	--	30	50	30	50	30	57	30	57	--	--	--	--
4	30	53	30	53	30	50	30	50	30	57	30	57	30	50	30	50
4.5	30	53	30	53	30	50	30	50	30	57	30	57	30	50	30	50
4.7	30	53	30	63	30	50	30	60	30	57	35	65	--	--	--	--
5	30	53	30	63	30	50	30	60	30	57	35	65	30	50	30	60
6	30	53	30	63	30	50	30	60	30	57	35	65	30	50	30	60
6.3	30	53	30	63	30	50	30	60	30	57	35	65	--	--	--	--
7	30	53	35	63	30	50	35	60	30	57	35	65	30	50	35	60
8	30	53	35	63	30	50	35	60	30	57	35	65	30	50	35	60
9	--	--	--	--	30	60	35	60	30	57	35	65	--	--	--	--
10	30	63	35	73	30	60	35	70	30	57	35	65	30	50	35	70
11	--	--	--	--	30	60	35	70	--	--	--	--	--	--	--	--
12	30	63	35	73	30	60	35	70	35	65	40	70	30	50	35	70
12.5	35	63	40	73	35	60	40	70	35	65	40	70	35	60	40	70
13	35	63	40	73	35	60	40	70	--	--	--	--	35	60	40	70
14	35	63	40	73	35	60	40	70	35	65	40	70	35	60	40	70
15	35	63	40	73	35	60	40	70	35	65	40	70	35	60	40	70
16	35	63	40	73	35	60	40	70	35	65	40	70	35	60	40	70
18	35	63	45	73	35	60	45	70	35	65	40	70	35	60	45	70
20	35	73	45	73	35	70	45	70	40	70	40	95	35	70	45	70
22	35	73	45	73	35	70	45	70	40	70	40	95	35	70	45	70
24	40	73	40	96	40	70	40	93	40	70	40	95	40	70	40	93
25	40	73	40	96	40	70	40	93	40	70	40	95	40	70	40	93
30	40	73	45	96	40	70	45	93	40	70	45	95	40	70	45	93
31.5	--	--	--	--	--	--	--	--	40	95	45	95	--	--	--	--
35	40	73	45	96	45	70	45	93	40	95	45	95	45	70	45	93
40	40	73	50	95	45	70	50	92	40	95	50	105	45	70	50	92
45	40	96	50	95	40	93	50	92	40	95	50	105	40	93	50	92
50	40	96	50	103	40	93	50	100	40	95	50	105	40	93	50	100
55	45	96	50	123	45	93	50	120	45	95	50	116	45	93	50	120
60	45	96	50	123	45	93	50	120	45	95	50	116	45	93	50	120
65	45	96	55	123	45	93	55	120	45	95	55	120	45	93	55	120
70	50	95	55	123	50	92	55	120	50	106	55	120	50	92	55	120
75	50	95	55	123	50	92	55	120	50	106	55	120	50	92	55	120
80	50	95	55	123	50	92	55	120	50	106	55	120	50	92	55	120
85	50	95	60	123	50	92	60	120	50	106	60	120	50	92	60	120
90	50	103	60	123	50	100	60	120	50	106	60	120	50	100	60	120
100	50	103	60	123	50	100	60	120	50	106	60	120	50	100	60	120

Part number code for Pitch from type (JFS-10 ~ JFS-26) : 000
 JFS 13 A3 107 J 000 000 B (Example: JFS-13 100uF 250VAC +/-5%)

Please visit our website to get more update data, those data & specification are subject to change without notice.

Motor Capacitor CBB60– JFS

Dimensions For Motor Running Capacitors CBB60

(mm)

CAP	JFS-15				JFS-16				JFS-17				JFS-18			
	250VAC		450VAC		250VAC		450VAC		250VAC		450VAC		250VAC		450VAC	
uF	D	H	D	H	D	H	D	H	D	H	D	H	D	H	D	H
1	30	57	30	57	30	60	30	60	30	60	30	60	30	53	30	53
1.5	30	57	30	57	30	60	30	60	30	60	30	60	30	53	30	53
2	30	57	30	57	30	60	30	60	30	60	30	60	30	53	30	53
2.5	30	57	30	57	30	60	30	60	30	60	30	60	30	53	30	53
3	30	57	30	57	30	60	30	60	30	60	30	60	30	53	30	53
3.5	30	57	30	57	30	60	30	60	30	60	30	60	30	53	30	53
3.75	30	57	30	57	--	--	--	--	30	60	30	60	30	53	30	53
4	30	57	30	57	30	60	30	60	30	60	30	60	30	53	30	53
4.5	30	57	30	57	30	60	30	60	30	60	30	60	30	53	30	53
4.7	--	--	--	--	--	--	--	--	--	--	--	--	30	53	30	63
5	30	57	35	65	30	60	30	60	30	60	30	60	30	53	30	63
6	30	57	35	65	30	60	30	60	30	60	30	60	30	53	30	63
6.3	30	57	35	65	30	60	30	60	30	60	30	60	30	53	30	63
7	30	57	35	65	30	60	35	63	30	60	35	68	30	53	35	63
7.5	--	--	--	--	30	60	35	63	--	--	--	--	--	--	--	--
8	30	57	35	65	30	60	35	63	30	60	35	68	30	53		
9	30	57	35	65	30	60	35	63	--	--	--	--	--	--	--	--
10	30	57	35	65	30	60	40	73	30	60	40	73	30	63	35	73
12	30	57	40	70	30	60	40	73	30	60	40	73	30	63	35	73
12.5	35	60	40	70	35	63	40	73	35	63	40	73	35	63	35	73
13	--	--	--	--	35	63	40	73	--	--	--	--	--	--	--	--
14	35	60	40	70	35	63	40	73	35	63	40	73	35	63	40	73
15	35	60	40	70	35	63	40	73	35	63	40	73	35	63	40	73
16	35	60	40	70	35	63	40	73	35	63	40	73	35	63	40	73
18	35	60	40	70	35	63	40	98	35	63	40	73	35	63	45	73
20	40	70	40	95	40	73	40	98	40	73	40	98	35	73	45	73
22	40	70	40	95	40	73	40	98	40	73	40	98	35	73	45	73
24	40	70	40	95	40	73	40	98	40	73	40	98	40	73	40	96
25	40	70	40	95	40	73	40	98	40	73	40	98	40	73	40	96
30	40	70	45	95	40	73	45	98	40	73	45	98	40	73	45	96
33	--	--	--	--	--	--	--	--	--	--	--	--	45	73	45	96
35	40	95	45	95	40	98	45	98	40	98	45	98	45	73	45	96
40	40	95	50	105	40	98	50	109	40	98	50	109	45	73	50	95
45	40	95	50	105	40	98	50	109	40	98	50	109	40	96	50	95
50	40	95	50	105	40	98	50	109	40	98	50	109	40	96	50	103
55	45	95	50	116	45	98	50	119	45	98	50	119	45	96	50	123
60	50	106	50	116	45	98	50	119	45	98	50	119	45	96	50	123
65	50	106	55	120	45	98	55	123	45	98	55	123	45	96	55	123
70	50	106	55	120	50	109	55	123	50	109	55	123	50	95	55	123
75	50	106	55	120	50	109	55	123	50	109	55	123	50	95	55	123
80	50	106	55	120	50	109	60	123	50	109	60	123	50	95	55	123
85	50	106	60	120	50	109	60	123	50	109	60	123	50	95	60	123
90	50	106	60	120	50	109	60	123	50	109	60	123	50	103	60	123
100	50	106	60	120	50	109	60	123	50	109	60	123	50	103	60	123

Part number code for Pitch from type (JFS-10 ~ JFS-26) : 000

JFS 13 A3 107 J 000 000 B (Example: JFS-13 100uF 250VAC +/-5%)

Please visit our website to get more update data, those data & specification are subject to change without notice.